

RESIDENTIAL DATA REPORT



WWW.ALLIEDAPPRAISERS.COM

4018 MILLER ROAD
FLINT, MICHIGAN 48507

PHONE: (810) 767-1444 • FAX: (810) 767-3866

Property Location:	225 SUNSET DRIVE LEGAL DESCRIPTION ATTACHED TO ADDENDUM. FLINT, MI 48502
Borrower:	JAMES & MARY SMITH
Client:	JOHN DOE REALTY COMPANY 123 MAIN STREET HOLLYWOOD, MI 48567
Effective Date:	5/15/2004
Prepared By:	ERIC DEAN MORSE, RAA MICHIGAN LICENSE #1201000920 eric@alliedappraisers.com



4018 MILLER ROAD
FLINT, MI. 48507

OFFICE (810) 767-1444 / FAX (810) 767-3866

Subject Photo Page

Borrower/Client JAMES & MARY SMITH				
Property Address 225 SUNSET DRIVE				
City FLINT	County GENESEE	State MI	Zip Code	48502
Lender JOHN DOE REALTY COMPANY				

Subject Front



Subject Rear



Subject Street



Building Sketch

Borrower/Client JAMES & MARY SMITH			
Property Address 225 SUNSET DRIVE			
City FLINT	County GENESEE	State MI	Zip Code 48502
Lender JOHN DOE REALTY COMPANY			

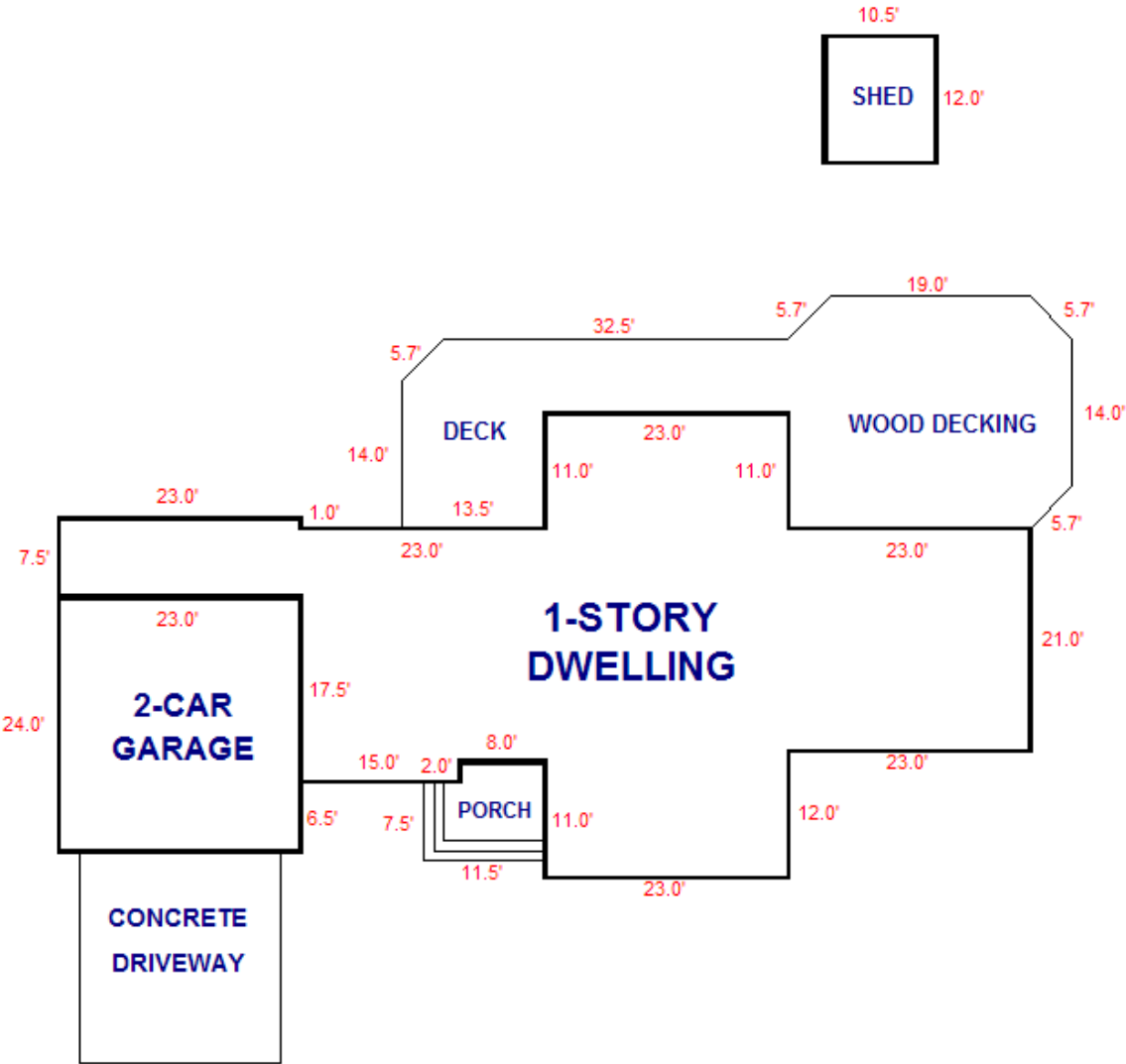

Sketch by Apex IV Windows™

Comments:

AREA CALCULATIONS SUMMARY			
Code	Description	Size	Net Totals
GLAL	First Floor	2203.50	2203.50
BSMT	Basement	2203.50	2203.50
P/P	Porch	102.25	
	Wood Decking	966.00	1068.25
GAR	Garage	552.00	552.00
OTH	Storage Shed	126.00	126.00
TOTAL LIVABLE (rounded)			2204

LIVING AREA BREAKDOWN		
Breakdown	Subtotals	
First Floor		
21.0 x 23.0		483.00
7.5 x 23.0		172.50
15.0 x 24.0		360.00
8.0 x 22.0		176.00
23.0 x 44.0		1012.00
5 Calculations Total (rounded)		2204

Supplemental Addendum					File No.	SAMPLE SURVEY
Borrower/Client	JAMES & MARY SMITH					
Property Address	225 SUNSET DRIVE					
City	FLINT	County	GENESEE	State	MI	Zip Code 48502
Lender	JOHN DOE REALTY COMPANY					

Legal Description

A PARCEL OF LAND BEGINNING SOUTH 00 DEGREES 23 MINUTES 12 SECONDS EAST 33.0 FEET FROM THE NORTH 1/4 CORNER OF SECTION: THENCE SOUTH 00 DEGREES 23 MINUTES 12 SECONDS EAST 118.66 FEET; THENCE ON A CURVE TO THE LEFT CHORD BEARING SOUTH 39 DEGREES 27 MINUTES 52 SECONDS WEST 497.46 FEET AND SOUTH 26 DEGREES 18 MINUTES WEST 138.68 FEET; THENCE ON CURVE TO THE LEFT CHORD BEARING NORTH 6 DEGREES 57 MINUTES 52 SECONDS EAST 93.88 FEET; THENCE NORTH 4 DEGREES 37 MINUTES EAST 238.66 FEET; THENCE ON A CURVE TO RIGHT CHORD BEARING NORTH 34 DEGREES 32 MINUTES 04 SECONDS EAST 357.21 FEET; THENCE NORTH 89 DEGREES 19 MINUTES 33 SECONDS EAST 143.74 FEET TO THE PLACE OF BEGINNING. SECTION 25, T5N-R5E, TOWNSHIP OF ARGENTINE, GENESEE COUNTY, MICHIGAN.

Site Area

2.51 +/- ACRES

Assessor's Parcel No.

25-01-25-100-015

Census Tract

26049-0130.02-1

Disclosure

THE FACTUAL INFORMATION CONTAINED WITHIN THE BODY OF THIS REPORT IS FOR REFERENCE PURPOSES ONLY. THIS IS NOT AN APPRAISAL REPORT AND MAKES NO REPRESENTATION AS TO THE MARKET VALUE OF THIS PROPERTY. THE DATA OBTAINED HERIN WAS OBTAINED FROM A PERSONAL INSPECTION OF THE PROPERTY, CITY AND/OR TOWNSHIP RECORDS, ONLINE INTERNET WEBSITES AND/OR DIRECT CONTACT WITH PERSONS INVOLVED WITH THIS PROPERTY (REALTORS/HOMEOWNERS, ETC). INFORMATION IS DEEMED RELIABLE BUT NOT GUARENTEED.